

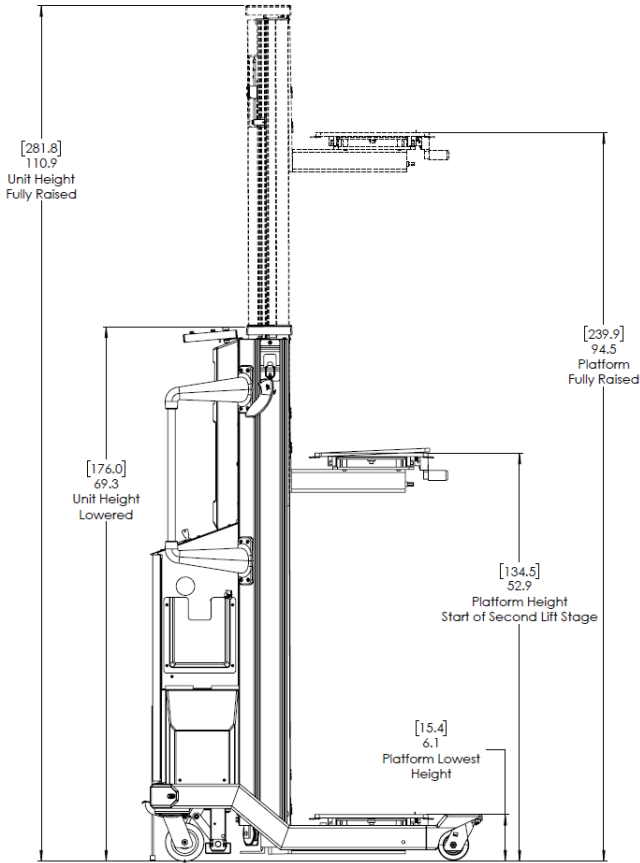

# SL-500X™ FINE ADJUST Electric Data Center Lift

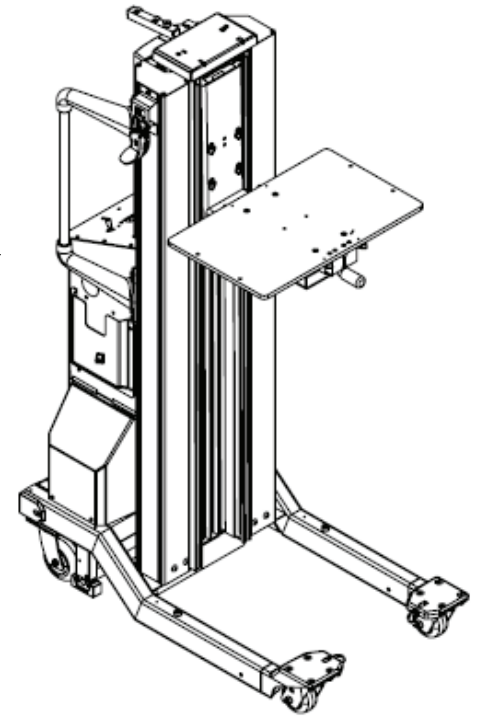

Dimensions: [cm] in

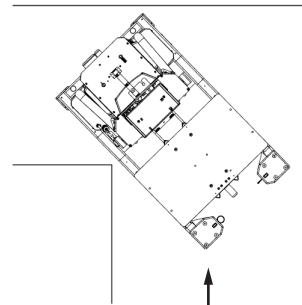

The lift can smoothly transition from a 32-inch aisle to a 40-inch aisle.

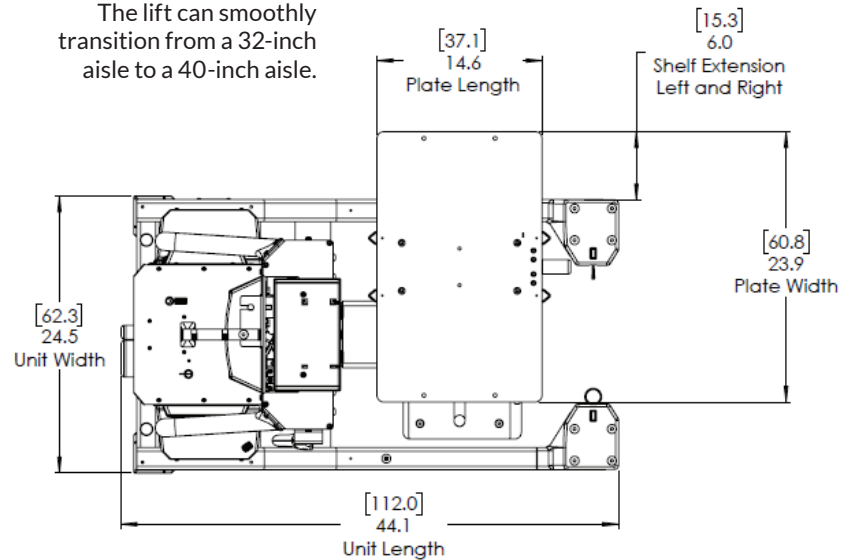

## Push joystick to move platform

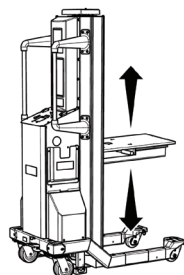
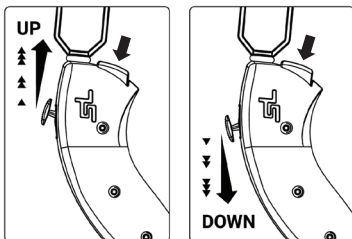

- ✓ The pendant can hang on either side of the lift.
- ✓ The pendant has progressive speed control for precise equipment positioning.
- ✓ The safety button must be held throughout the operation for safe use.

## Hang pendant on left or right side

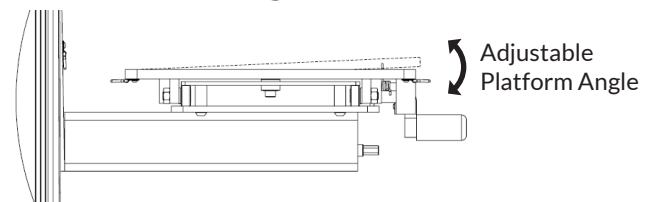
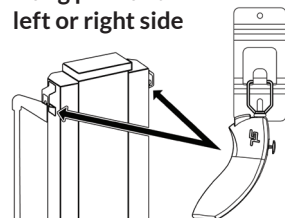

## Front Caster Swivel Lock Operation



## Capacity

DESCRIPTION	US (lb)	METRIC (kg)
Platform center (Platform retracted)	500	227
Platform edge (Platform extended)	300	136

## Weight

DESCRIPTION	US (lb)	METRIC (kg)
Total unit weight	455	206
Shipping weight	557	253