



# ***PL500A***

***Platform Extension***

## **Operator Manual**



Copyright © 2009 ServerLift Corporation

ServerLift PL500A Platform Extension - ***Operator Manual***

## Using Slings:

**STEP 4: Lower equipment down onto a secure surface.**

**STEP 5: Remove slings from brackets.**

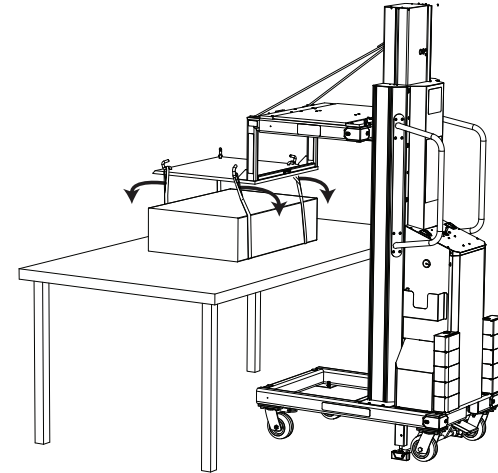

**STEP 6: Remove slings from under equipment.**

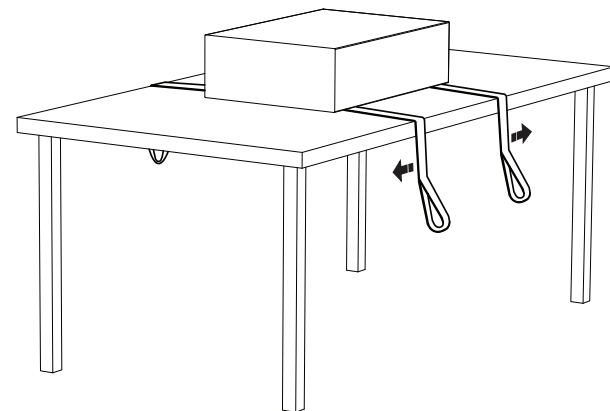

**Example of sling usage: *continued***

**STEP 2: Hook loop ends of slings on to brackets of the PL500A.**

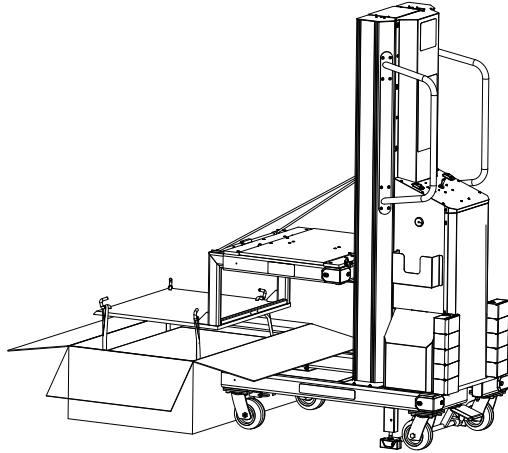

**STEP 3: Lift equipment out of box and remove packaging.**

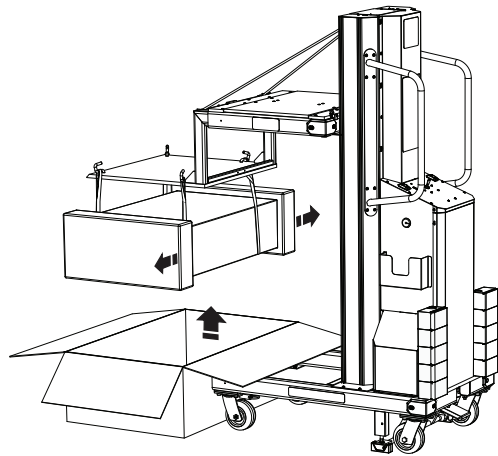

ServerLift Corporation  
821 N 2nd St.  
Phoenix, AZ 85004  
602.254.1557  
email: support@serverlift.com  
www.serverlift.com

© 2009 ServerLift Corporation, Phoenix, AZ  
Information in this document subject to change without notice.  
06-05-09 P/N RT-17672A Rev.A01

**⚠ CAUTION:**

- Read all instructions completely before using the PL500A.
- **IMPORTANT** - Keep these instructions with SL500 manual.
- Never use PL500A without the swing arm hook securely in place.
- Do not stand or ride on SL500 or PL500A.
- Do not exceed 500 lbs maximum load at PL500A center when using counterweights.
- Do not exceed 300 lbs maximum load at PL500A center when not using counterweights.

**Failure to follow load restrictions may result in tipping of ServerLift.**

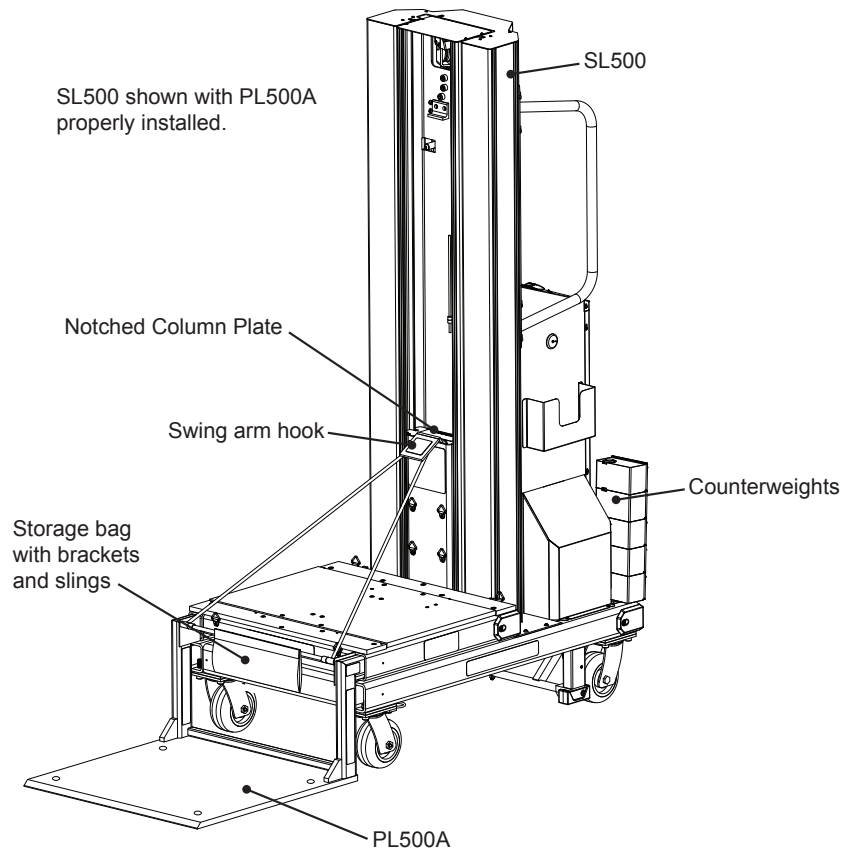

**Example of sling usage:**

**STEP 1: Feed straps under IT equipment while in box.**

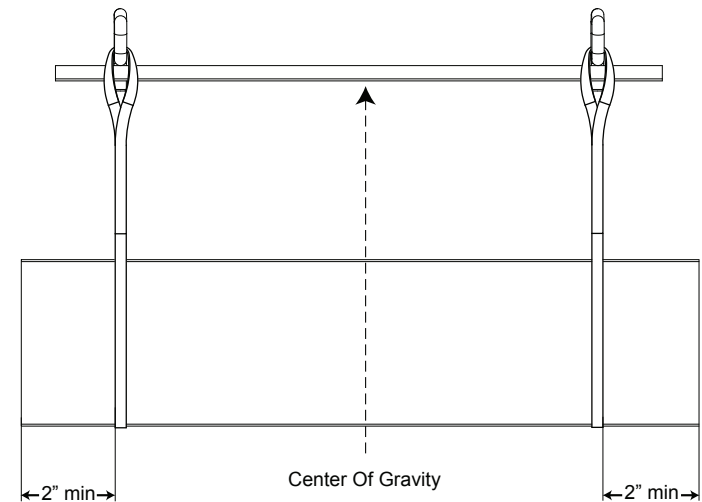
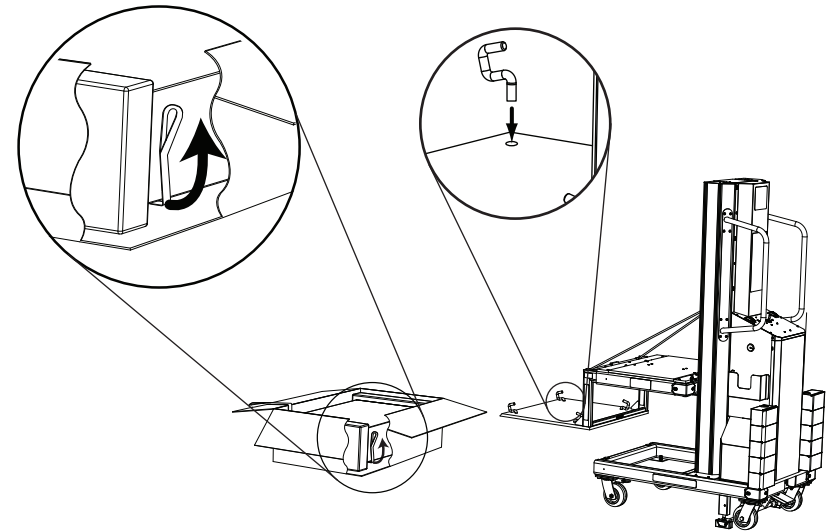

**⚠ CAUTION:**

**Center of gravity must be between brackets of PL500A.**

**Attaching the PL500A: *continued***

**STEP 8:** Attach Storage Bag by using the straps over the adjustment bar as shown.

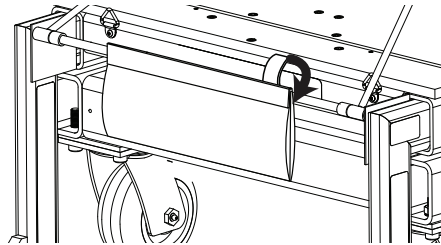

**Removing the PL500A:**

**STEP 1:** Lower SL500 platform until PL500A fully rests on the floor.

**CAUTION:**

- When lowering PL500A, the operator must be careful to lower only to point where there is no pressure on PL500A.

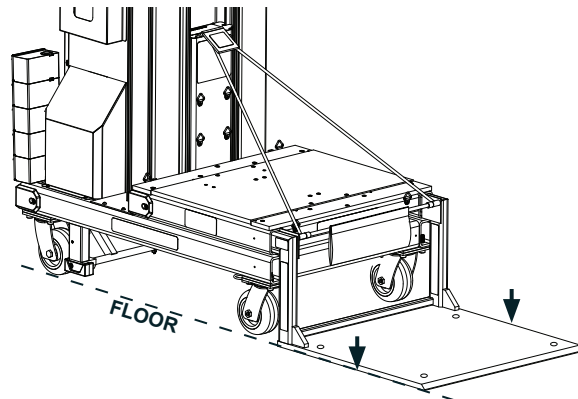

**STEP 2:** Release swing arm hook by lifting and rotating back until it rests on the floor.

**STEP 3:** Back SL500 away from PL500A.

**Before you begin:**

- Read these instructions completely and carefully.
- Prepare an area for installation with space for moving ServerLift.

**If you have questions, call 602.254.1557 or visit ServerLift website at: [www.serverlift.com](http://www.serverlift.com)**

Proper installation of this product is the responsibility of the installer.

**Parts and tools supplied for installation:**

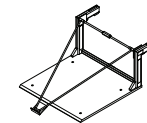

PL500A

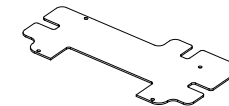

Notched Column Plate

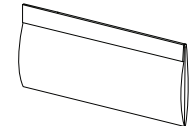

Storage bag for brackets and slings.



2mm hex wrench



2.5mm hex wrench



(4) Bracket

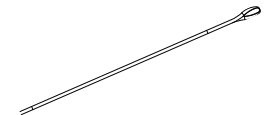

(2) Sling

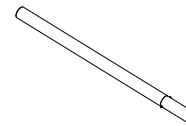

(2) Counterweight Post

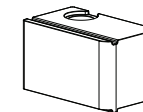

(2) Counterweight with Foam Adhesive

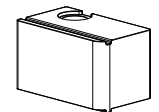

(8) Counterweight

**Tools required by customer for installation:**

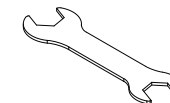

19mm crescent wrench (or adjustable wrench)

**Counterweight installation:**

**STEP 1:** Remove plastic caps as shown.

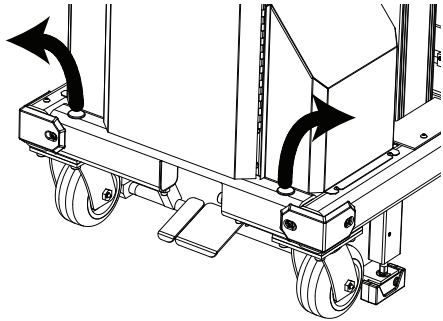

**STEP 2:** Insert Counterweight Posts into holes and over the screws and nuts inside support tube. (Open End Down)

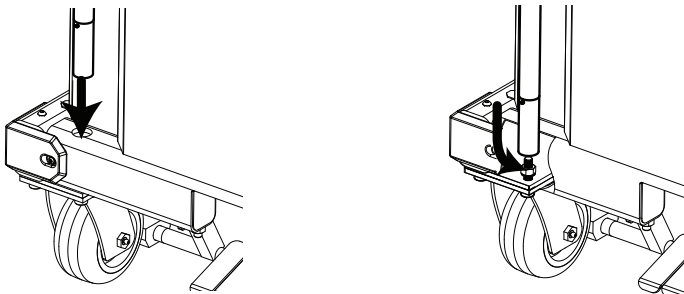

**STEP 3:** Place Counterweight with Foam Adhesive onto Counterweight Post as shown, with Foam Adhesive side down.

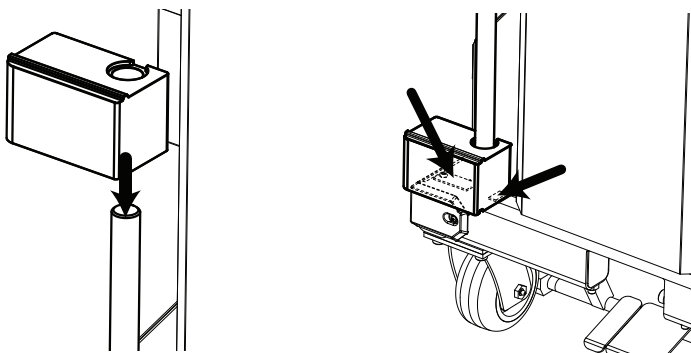

(STEP 6 APPLIES TO INITIAL INSTALLATION ONLY)

**Attaching the PL500A: *continued***

**STEP 6:** If platform supports will not align properly, use a 19mm crescent wrench to rotate the adjustment nut until platform support arms are aligned with the open ends of the SL500 platform.

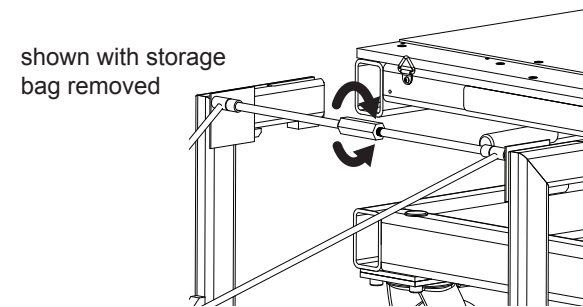

**STEP 7:** Rotate the swing arm hook as indicated and secure over the front edge of the SL500 column.

**⚠ CAUTION:**

PL500A should not be used unless swing arm hook is properly engaged.

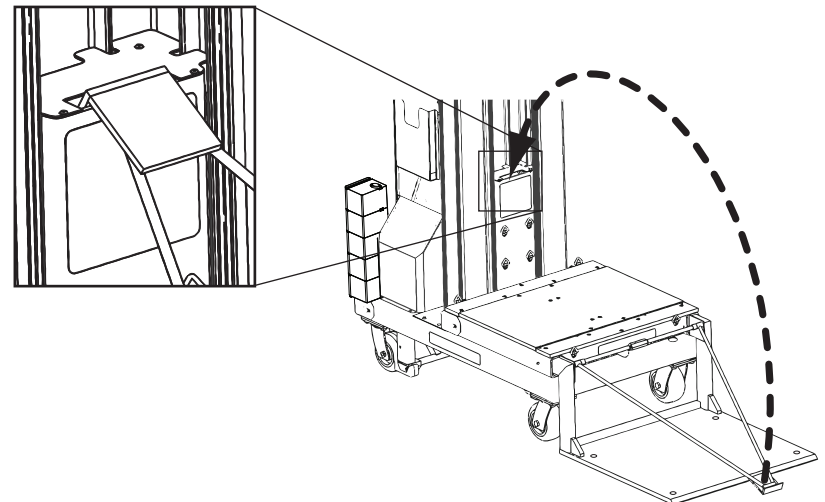

## Attaching the PL500A: *continued*

**STEP 5a:** Push PL500A so that the back end slightly hangs over the edge of the pallet.

**STEP 5b:** Push SL500 toward PL500A to fully insert PL500 platform supports in open ends of SL500 platform.

### ⚠ CAUTION:

- Confirm PL500A supports are fully inserted inside SL500 platform.

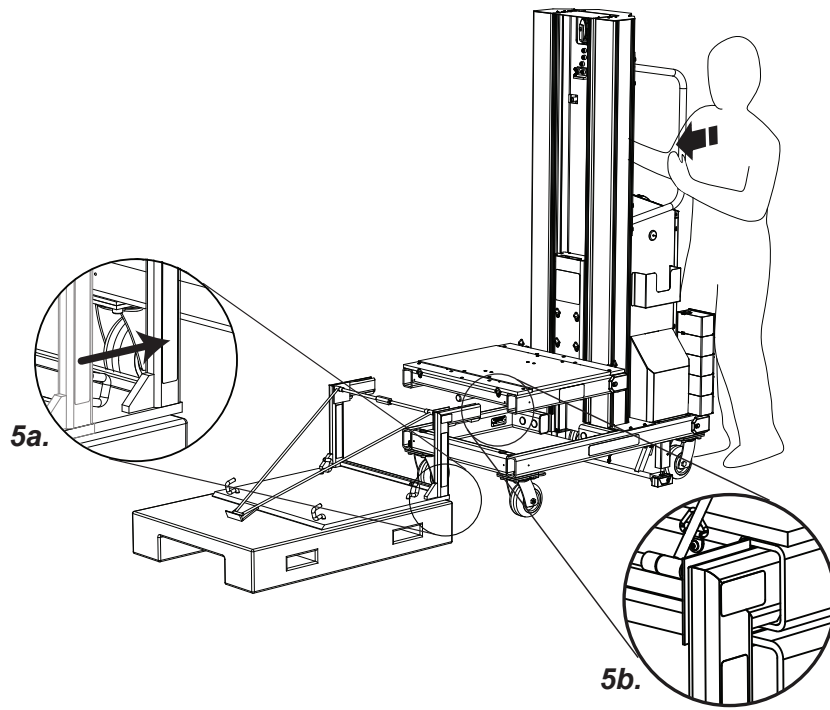

## Counterweight installation: *continued*

**STEP 4:** Place additional Counterweights onto Counterweight Posts, aligning the tongue and grooves. Repeat until you have all five Counterweights properly in place.

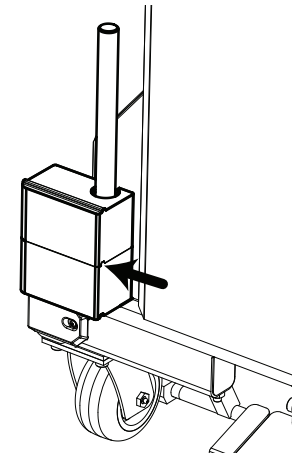

**STEP 5:** Repeat instructions for the other side of the SL500.

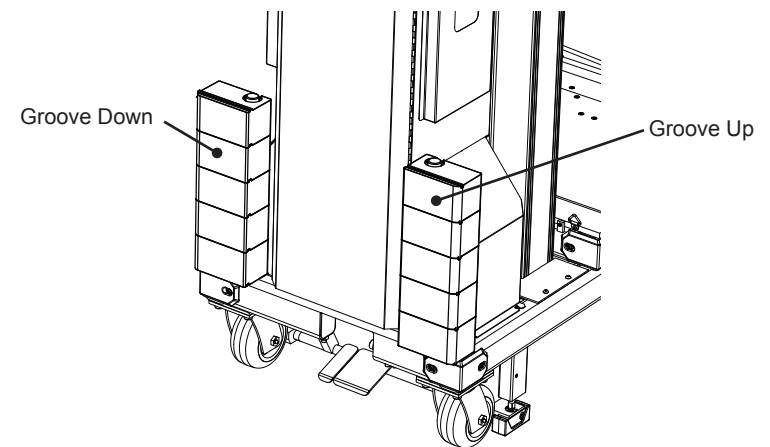

### Attaching the PL500A:

**CAUTION: FRONT CASTERS MUST BE LOCKED IN BACKWARD POSITION BEFORE INSTALLING PL500A.**

To engage swivel lock, pull ring out and turn 90 degrees in either direction. Then allow ring to align in horizontal grooves as shown.

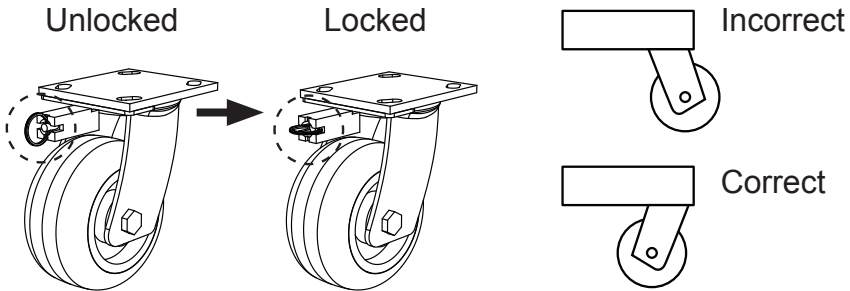

**STEP 1:** Remove packaging from PL500A.

**STEP 2:** Remove corner bumpers from the front of platform using a 2.5mm hex wrench (supplied).

NOTE: Must remove 4 front bumpers total - 2 on each side as shown.

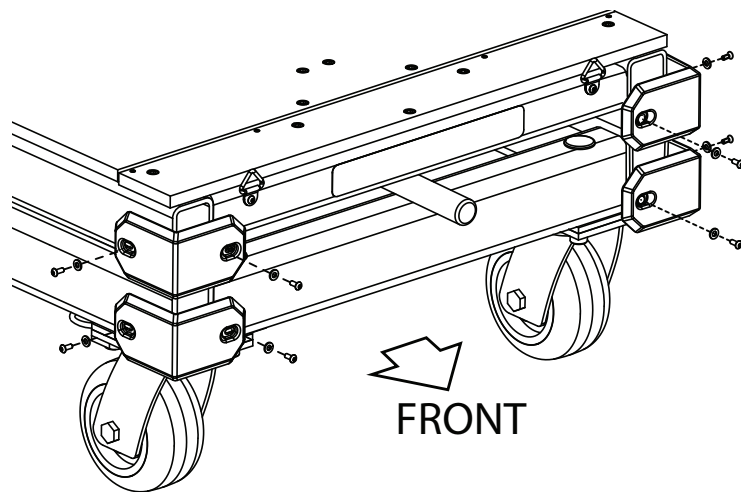

### Attaching the PL500A: *continued*

**STEP 3:** Remove the existing Column Plate using the 2mm hex wrench and replace it with the provided replacement Notched Column Plate.

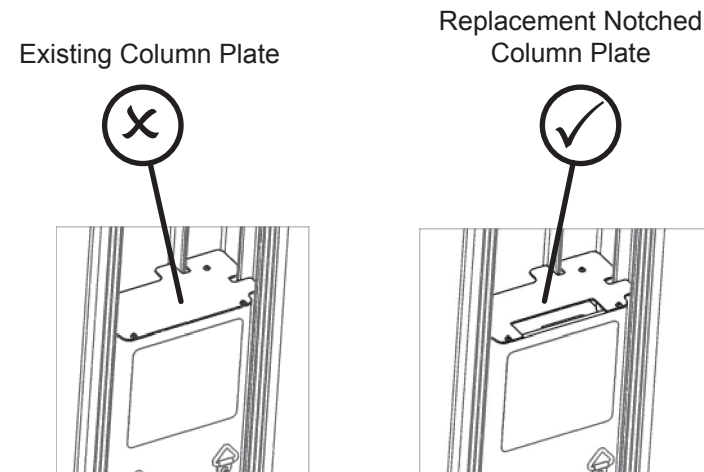

**STEP 4:** Adjust the SL500 platform up or down to align with PL500A as shown.

